



New Enterprise Stone & Lime Co., Inc.

## Project Spotlight

### MasterFiber<sup>®</sup> MAC Matrix Macrosynthetic Fiber

#### Location

Ephrata, PA

#### Contractor

Ruhlman Bros., Inc.

#### Concrete Producer

New Enterprise Stone & Lime Co., Inc.

#### Concrete Volume

48 yd<sup>3</sup>

#### Fiber Dosage

4.0 lb/yd<sup>3</sup>

#### Application

Slip form curb

### Wabash Landing Slip Form Curb



Project specified standard Penndot 16" slant curb reinforced with two #5 rebar.

Master Builders Solutions proposed eliminating the rebar and adding MasterFiber MAC Matrix synthetic fiber at a dosage of 4.0 lbs/yd<sup>3</sup> to provide shrinkage and temperature reinforcement. Contractor was able to extrude the curb without any adjustments to the mix or the curb machine.

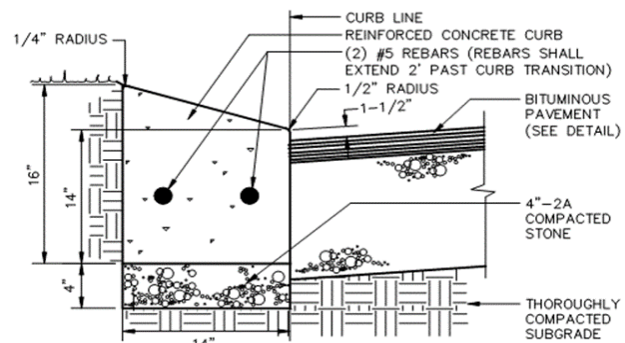

NOTE:  
CURB SHALL BE CONSTRUCTED IN ACCORDANCE WITH PENNDOT  
MANUAL FORM 408, SECTION 641, "PLAIN CEMENT CONCRETE  
CURB GUTTER, TYPE A, C AND D," AS AMENDED.

#### TYPICAL SLANT CURB DETAIL

NOT TO SCALE (BUMP-OUT AREAS ONLY)



Shrinkage & temperature crack control with corrosion resistant synthetic fibers

Potential for long term corrosion problems when using conventional rebar for shrinkage & temperature crack control

*Altoona Sales Area - Adrian "Ace" Snyder – 814.330.2425  
Harrisburg & Chambersburg Sales Area – Scott Eichelberger – 717.729.1816  
Lancaster Sales Area – Darryl Keiser – 717.286.5894  
Allentown Sales Area – Clint Renninger – 484.256.8343*